

ROOM SCHEDULE

NAME OF ROOM	NO.	FINISH FLOOR	WALLS	BASE	CEILING	TRIM	WAINSCOT
Gymnasium	17	Wood	brick	—	chased w/ tile suspended	—	—
Girls toilet	18	Asphalt	brick-painted	—	plastered	—	Banded S. Chubb
Chair storage	19	Grano	plastered	Wood	Wafershed	A.C. Pine	—
Storage	20	do	do	do	do	do	—
Class room	21	Mastic	plastered	2 Mastic Cove Wood base	plastered	Arh	hard plaster painted
ditto	22	do	do	do	do	do	do
ditto	23	do	do	do	do	do	do
Boys toilet	24	Asphalt	brick-painted	—	plastered	—	—
Kindergarden	25	Cork	plastered	2 Mastic Cove Wood base	do	Arh	Painted hard plaster painted
Coat room	25A	Grano fin.	do	Wood	plastered	N.C. Pine	do
Toilet	25B	Asphalt	do	2 Mastic Cove Wood base	do	do	do
Class room	26	Mastic	do	2 Mastic Cove Wood base	plastered	Arh	do
Teacher's office	27	do	do	do	do	do	—
Principal's office	28	do	do	do	do	do	—
Waiting room	29	do	do	do	do	do	—
Nurses room	30	do	do	do	do	do	—
Doctor's room	31	do	do	do	do	do	—
Drum room	32	do	do	do	do	do	—
Class room	33	do	do	do	do	do	hard plaster painted
ditto	34	do	do	do	do	do	do
Stage	No Number	do	brick	—	plastered	—	—

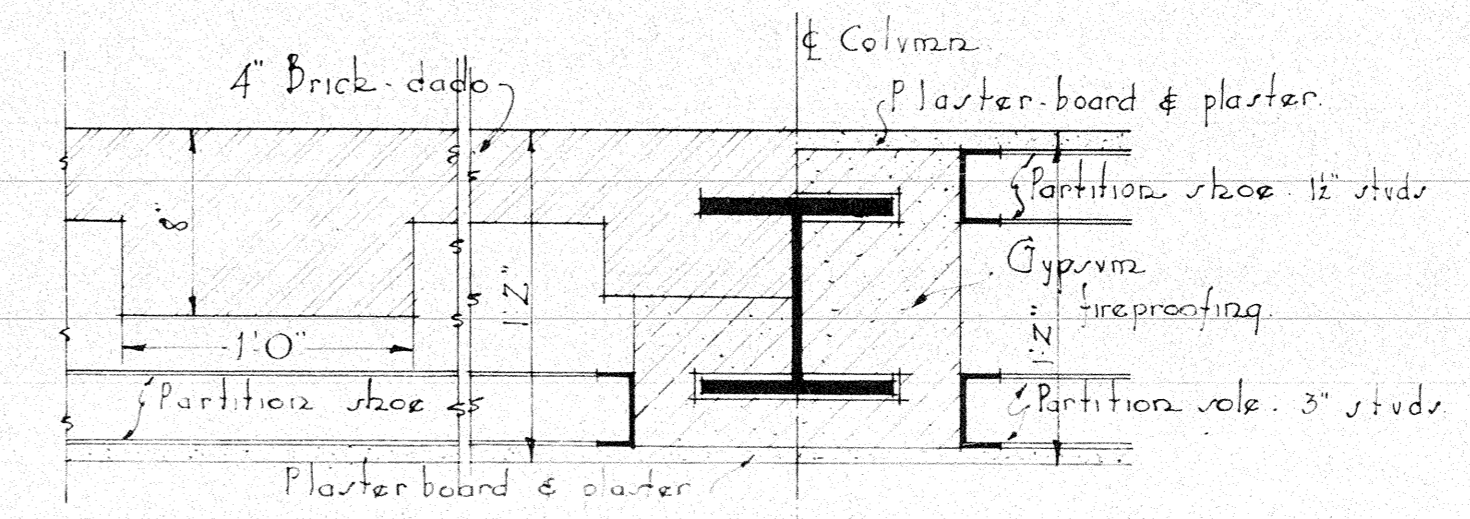

PLAN - THRU - PLAN - THRU - PLAN - ABOVE - BUTTRESS - BRICK - DADO - BRICK - DADO -

Scale 1/2" = 1'-0"
CORRIDOR COLUMN

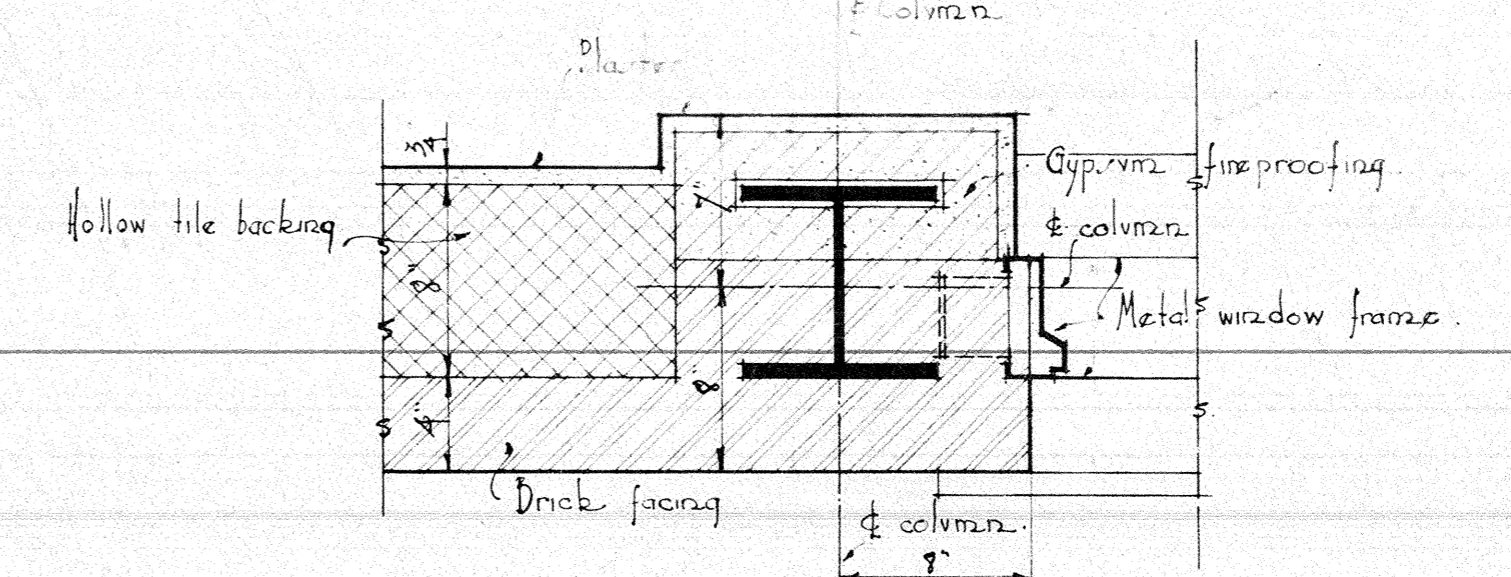

Scale 1/2" = 1'-0"
EXTERIOR COLUMN

DOOR SCHEDULE

A - 3'-2" x 7'-0" x 1 1/2" - 2 panels - glass divided 6 lights

B - 2'-8" x 7'-0" x 1 1/2" - 2 panels

C - 2'-6" x 7'-0" x 2 1/4" - single panel - clear wire glass

D - 2'-6" x 7'-0" x 1 1/2" - 2 panels - upper panel clear wire glass

E - 2'-4" x 7'-0" x 1 1/2" - Kalamazoo - single panel - clear wire glass

F - 2'-0" x 6'-8" x 1 1/2" - 2 panels

Note: 'A' doors in gymnasium to have 4" clear wire glass in upper panel.

'A' doors in rooms 18 & 24 to be glazed with obscure glass.

All 'A' doors to stair towers to be glazed with 1" obscure wire glass.

'B' door in room 29 to have obscure glass in upper panel.

G - 5'-0" x 7'-6" x 2 1/4" - single panel - bevel plate glass - see specifications.

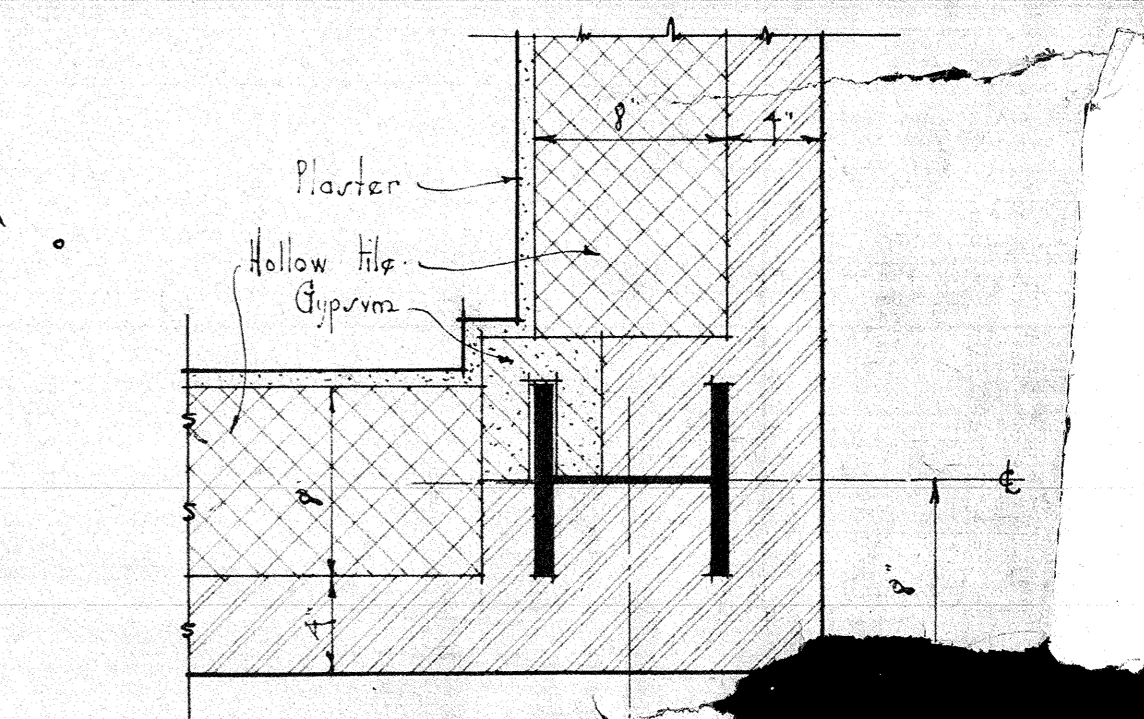

Scale 1/2" = 1'-0"
EXTERIOR CORNER COLUMN

APPROVED: _____ MAYOR

FIRST FLOOR
SCALE 1/8" = 1'-0"

The Elias Brookings School
FOR
The City of Springfield, Mass.

DR. A. I. M.	Morris W. Maloney,	ARCHITECT 23 PEARL STREET, SPRINGFIELD, MASS.
TR. M. C.		
Commission 227	Date 9	Revised